

TRABE

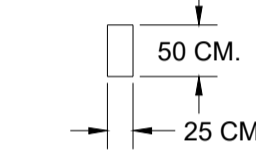

COLUMNA

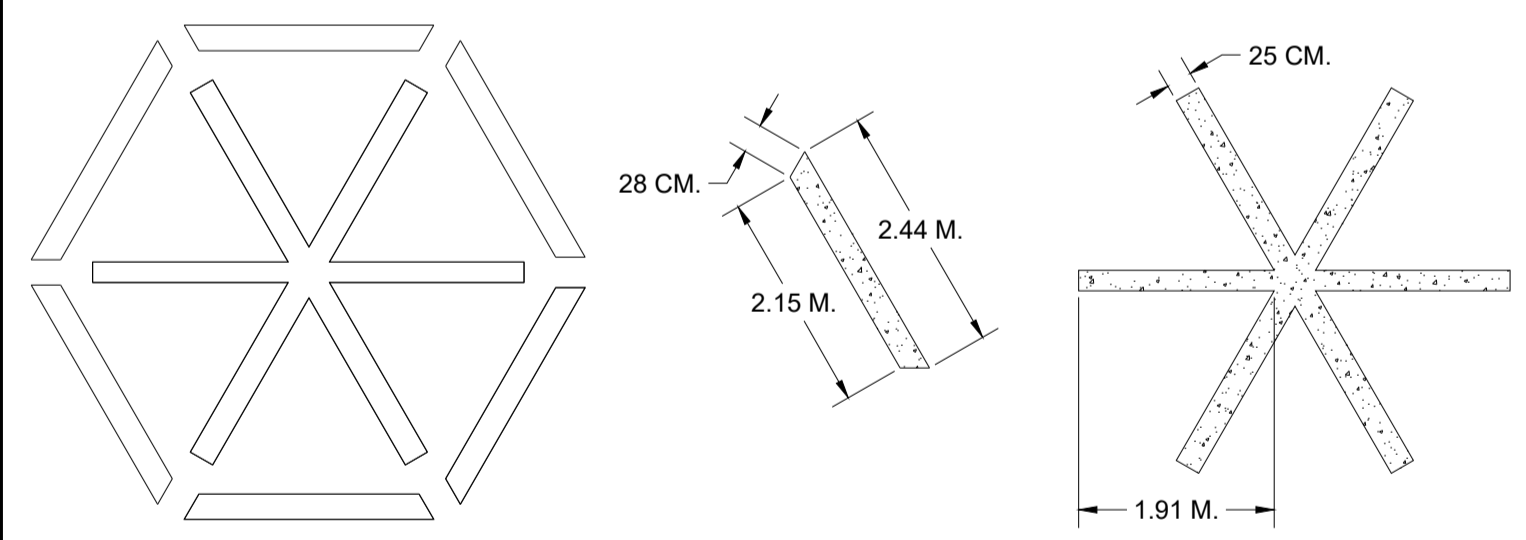
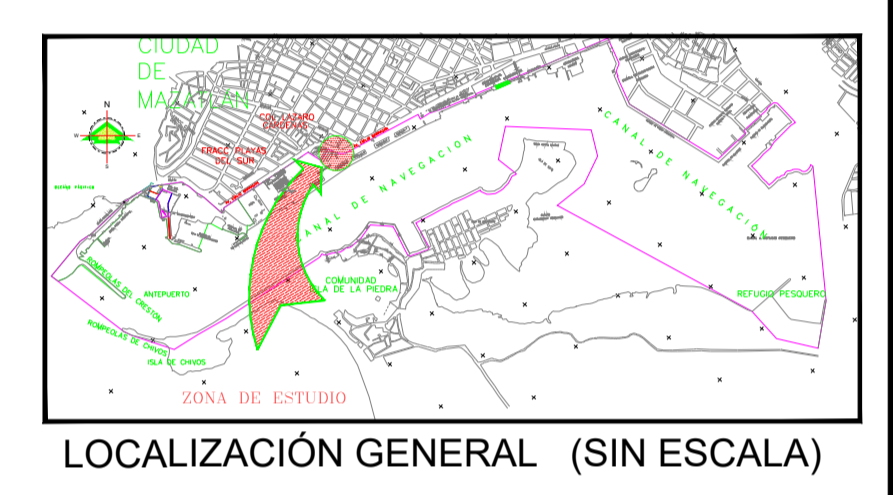
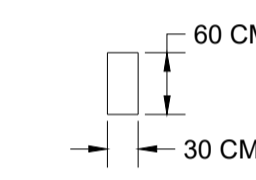

DETALLE N° 1
ÁREA = 6.2513 M2

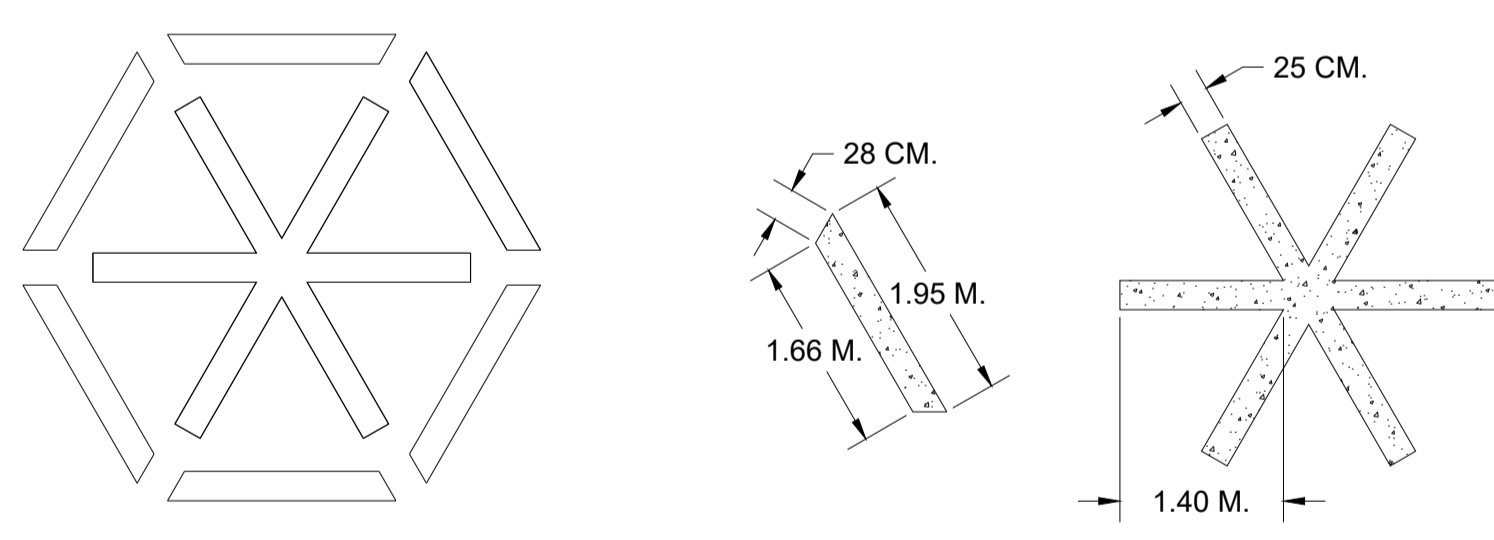

DETALLE N° 2
ÁREA = 4.9715 M2

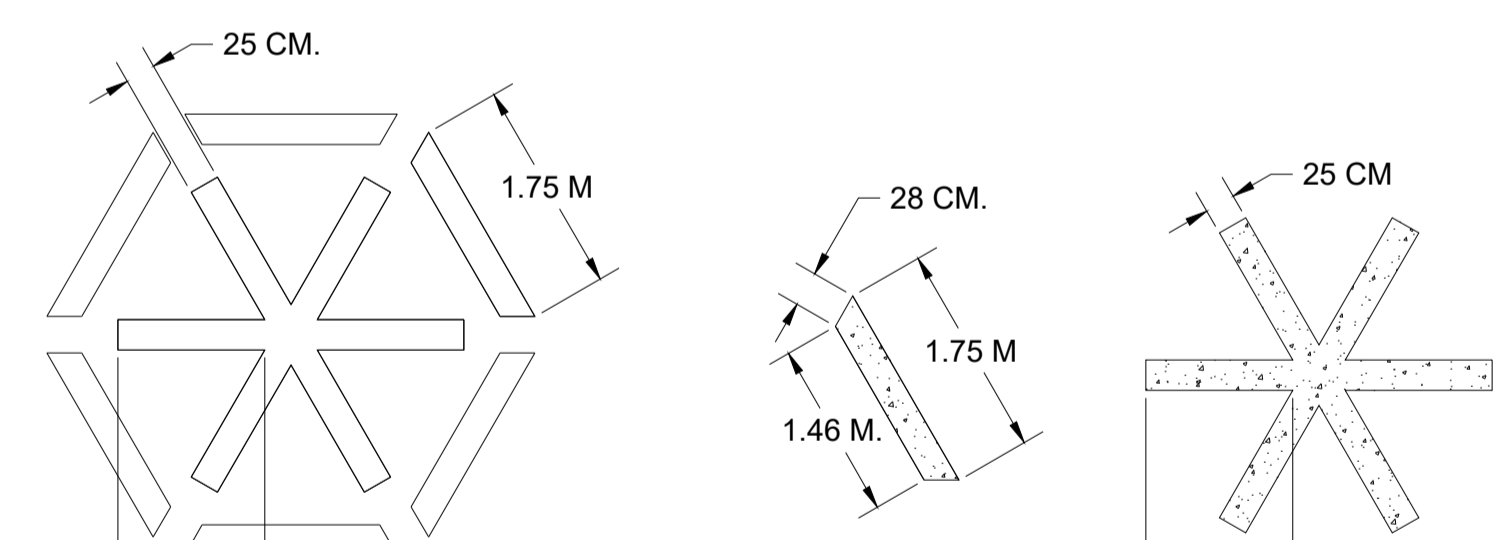

DETALLE N° 3
ÁREA = 4.3932 M2

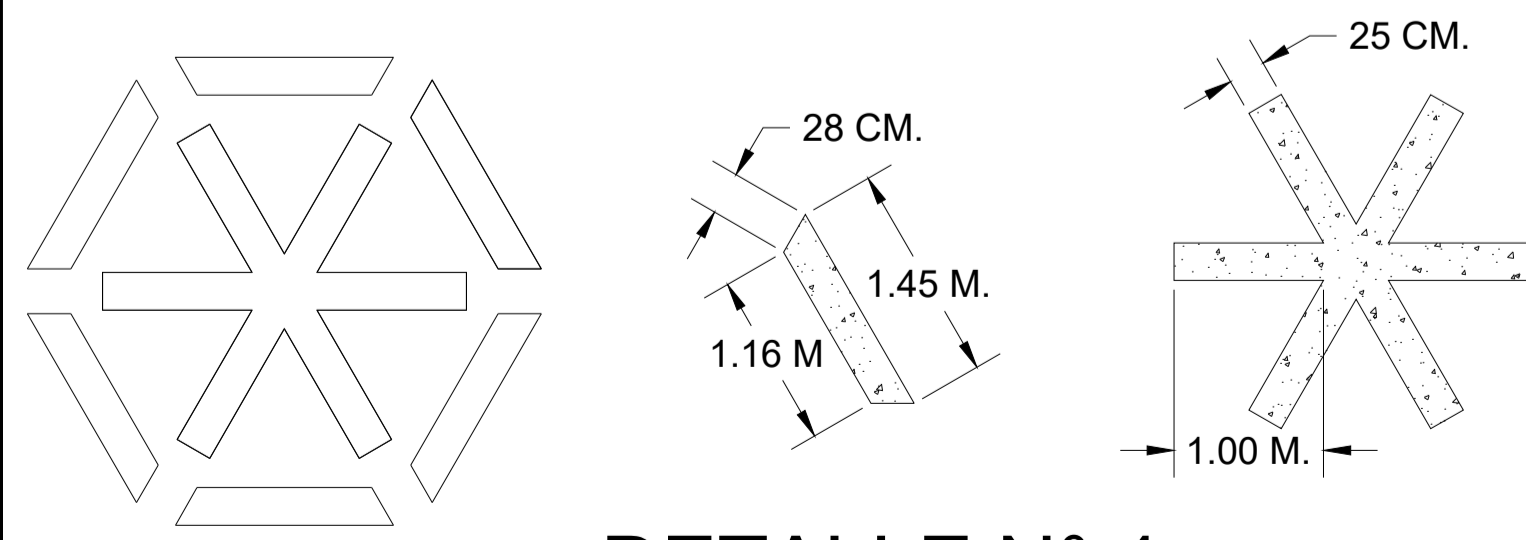

DETALLE N° 4
ÁREA = 3.6216 M2

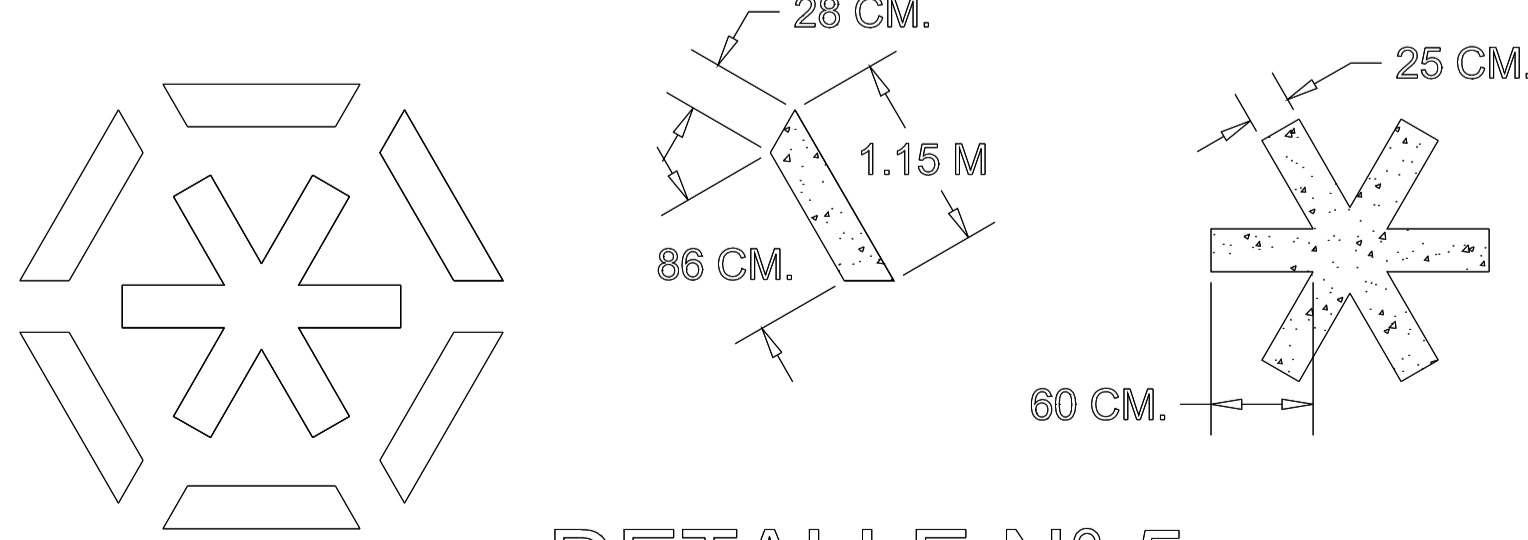

DETALLE N° 5
ÁREA = 2.5715 M2

DIRECTOR GENERAL
CONTRALMIRANTE MARIEL AGUILO ANCONA INFANCON
GERENTE DE OPERACIONES E INGENIERIA
ARQ. PEDRO LINO MUÑOZ CIURANA
SUBGERENTE DE INGENIERIA Y ECOLOGIA
ING. FRANKLIN ALONSO BENITEZ CASANOVA

ADMINISTRACION DEL SISTEMA PORTUARIO
NACIONAL MAZATLAN S.A. DE C.V.
"DEMOLICIÓN DE TORRE EN ESTACIONAMIENTO DE OFICINAS DE
DIRECCIÓN GENERAL ASIPONA, MAZATLÁN, SIN.."
PLANO GENERAL
Fecha: JULIO 2022 Estado: INICIADAS Plano N° ASIPONAMAZ-22-2022-1281